



01. Landscape Layout, Scale 1:500 @ A1

KEY

- Existing tree to be retained with pruning work as per arboriculturist recommendations
- Existing tree to be removed with all limbs and cuttings removed from site
- Aesculus hippocastanum*, 16-18cm, 4.5M high, 2M clear stem, wire rootballed
- Quercus robur*, 16-18cm, 4.5M high, 2M clear stem, wire rootballed
- Pinus sylvestris*, 16-18cm, 4.5M high, 2m Clear Stem, wire rootballed
- Malus 'Evereste'*, 16-18cm, 4.5M high, 1.5M clear stem, wire rootballed.
- Malus 'Coxs Self Fertile'*, 16-18cm, 4.5M high, 1M clear stem, wire rootballed.
- Prunus accolade*, 16-18cm, 4.5M high, 1.5M clear stem, wire rootballed.
- Tilia cordata 'Greenspire'*, 16-18cm, 4.5M high, 2M clear stem, Wire rootballed
- Quercus phellos*, 16-18cm, 4.5M high, 2M clear stem, Wire rootballed.
- Acer campestre 'elsrijk'*, 16-18cm, 4.5M high, 2M clear stem, Wire rootballed.
- Sorbus aria 'lutescens'*, 16-18cm, 4.5M high, 2M clear stem, Wire rootballed.
- Prunus maackii 'amber beauty'*, 16-18cm, 4.5M high, 2m clear stem, wire rootballed.
- Sorbus aucuparia 'Joseph rock'*, 16-18cm, 4.5M high, 2m clear stem, wire rootballed.
- Salix babylonica*, 18-20cm, 4.5M high, 3M clear stem, Rootballed
- Salix alba*, Multistem, 1.5-2M high, 2x transplanted, 3-5breaks, bare root.
- Betula albonensis 'Fascination'*, 2-2.5M high, Multistem, 3-5 breaks, wire rootballed.
- Sorbus spp.*, 14-16cm, 3M high, 1.5M clear stem, wire rootballed.
- Alnus glutinosa*, 14-16cm, 3M high, 1.5M clear stem, wire rootballed.
- Betula pendula*, 14-16cm, 3M high, 1.5M clear stem, wire rootballed.
- Salix caprea*, 14-16cm, 3M high, 1.5M clear stem, wire rootballed.
- Specimen Shrub: *Amentanchier lamarkii*, min 3 breaks, 1.5M spread, 190L pot
- Specimen Shrub: *Rhys typhina*, Multi stem, 3-5 breaks, 1.75M high, 12L pot
- Carpinus betulus* hedge, 1000-1200mm high planted in 3m staggered lines (1 Meter) wide @ 9 plants per linear meter. Plants supplied bare root 2+2
- Acer campestre* hedge, 1000-1200mm high planted @ 300mm centers in staggered rows. Plants supplied bare root 2+2
- Corylus avellana 'Contorta'* hedge, 1000-1200mm high planted @ 300mm centers in staggered rows. Plants supplied bare root 2+2
- Prunus lusitanica* hedge, 5 plants per linear metre, staggered row, 1000-1200mm high, Bareroot
- Native hedge mix, see planting specification below
- Grass Lawn, low maintenance grass seed mix - 150mm BS certified topsoil to be managed as grassland.
- Proposed Wildflower Meadow - Wildflower meadow allowed to naturally develop from seed present in the soil matrix. Surface to be finished with 150mm subsoil/topsoil mix with low maintenance regime.
- Planting Block 01- Low maintenance ornamental grass block - 450mm BS certified topsoil.
- Planting Block 02- Mixed low maintenance perennials and ornamental grasses - 450mm BS certified topsoil.
- Planting Block 03- 40% Evergreen Boundary screening mix.
- Single species *Fagus sylvatica* block cut to 1M high - 450mm BS certified topsoil.
- Single species *Amentanchier lamarkii* shrub block cut to 1M high - 450mm BS certified topsoil.
- Wet woodland wildflower meadow area
- Grass reinforcement block paving system by Tobermore Turfstone or equal and approved
- Compacted fines path, 8mm-dust buff aggregate with softwood treated timber edge.
- FSC Hardwood timber decking on FSC treated softwood bearers.
- Bark mulch safety surfacing, depth to equipment fall heights.
- Carriageway in hot rolled asphalt surfacing to engineers specification.
- Plaza Paving, concrete slab with granite aggregate, silver granite colour, units 600mm x 150mm x 80mm, laid in stretcher bond.
- Park Paths Paving, concrete slab with granite aggregate, sandstone colour, units 200mm x 100mm x 60mm, laid in stretcher bond.
- Insitu concrete footpath with brushed finish, expansion joints and mix to engineers specification.
- Residential paving to back of houses, concrete flag with granite aggregate, silver grey colour, units 300mm x 600mm x 50mm, laid in stack bond.
- Residential paving to front of houses, concrete block with granite aggregate, graphite grey colour, units 100mm x 200mm x 60mm, laid in stack bond.
- Rounded play boundaries by Caledonian Play Boulders or equal approved 650 - 1200mm long, 450mm max high.
- Rough and ready bench seat, 450mm H x 2000mm L x 500mm W by Streetlife or equal and approved.
- Wooden girder bridge, FSC hardwood posts and decking. 5M long x 2M wide. Substructure in galvanized steel.
- Rough&Ready Picnic Set by Streetlife or equal and approved.
- Stainless steel cycle stands 825x850x48mm, S36 by Omos or equal and approved.

PLANTING NOTES

- Ornamental plants to be supplied in p9 pots except where stated otherwise.
- All trees and shrubs to be supplied and planted following BS 5396.
- All plant material to be inspected by the Landscape Architect prior to planting.
- All existing vegetation to be removed and cleared of site
- Shrub planting beds to be 450mm good quality topsoil to BS 3882 (Certs required, LA to inspect prior to commencement on site).
- Tree pit shall be excavated not more than 2 days prior to planting.
- All tree pits to maintain horizontal base and vertical sides, sides to be scarified, pit bottom to be broke up to to a depth of 200mm with slightly raised centre.
- Trees to be planted upright with collar at finished soil level and back filled with previously prepared planting material.
- All new trees should be staked using a short double timber staking system mature relocated trees to be guyed where required.
- Time scale for implementation:
 - Deciduous trees and shrubs - Late October to late March
 - Herbaceous plants: September/October and March/April
 - Container grown plants: At any time if conditions are favorable
- All construction works to be carried out to manufactures recommendations regarding climatic conditions and controls.
- Wet wildflower mix:
 - Mow existing wildflower turf to 75mm
 - Lift existing wildflower turf using a turf cutter
 - Once lifted ensure that turf rolled and is relayed within the same day.
 - Remove any surface stone, clods, other debris and perennial weeds.
 - Once loosened the soil should be lightly compacted by walking over the whole area and then again at right angles to the first direction.
 - Break up any heavily compacted areas using a fork and fill any dips, lightly compacting. Then rake the surface to a fine tilt and make sure that the surface is level.
 - Before laying turf soak soil onto which sod is to be laid.
 - Do not use any heavy equipment on the prepared soil, such as roller, as this will compact the soil too much.
 - Keep newly laid turf well watered for establishment phase.

Notes:

- All back gardens leveled to a achieve max 1:10 gradient where possible. Where falls do not allow 1:10 lawn a rendered block retaining wall will be constructed with 1.2M wide central steps (150mm riser, 300mm tread) to a max height of 600mm.
- For all structural, levels and drainage information refer to engineers drawings.
- Works to Existing trees
 - All trees to be retained to be accessed by qualified arboriculturist before breaking ground onsite, any trees deemed dangerous to be removed, tree works, limb removal and canopy works to be carried out in line with arboriculturist instructions.
 - All works around trees to be carried out in accordance with British Standards for Tree protection BS 5837:2012
 - Areas immediately below the canopy of the existing trees to be retained within the site to be protected in line with BS standard BS587:2012- 6.2.2, using a vertical and horizontal scaffold framework, well braced to resist impacts. Vertical tubes should be spaced at a maximum interval of 3m and driven securely into the ground. Welded mesh panels should be securely fixed to this framework. Care should be exercised when locating the vertical poles to avoid under-ground services and, in the case of the bracing poles, also to avoid contact with structural roots. If the presence of under-ground services precludes the use of driven poles, an alternative specification should be prepared in conjunction with the project arboriculturist that provides an equal level of protection. Such alternatives could include the attachment of the panels to a free standing scaffold support framework.
 - Contractor to confirm location. All temporary fencing to be removed on completion by contractor.
 - All-weather notices should be attached to the barrier with words such as: "CONSTRUCTION EXCLUSION ZONE - NO ACCESS".
 - Tree root protection areas (RPA) shown are a guide only and should be calculated and marked onsite, for single stem trees, the RPA should be calculated as an are equivalent to a circle with a radius 12 times the stem diameter as per BS587:2012- 4.6.1
 - For trees with more than one stem see BS587:2012- 4.6.

PLANTING SCHEDULE

- Planting Block 01:** Ornamental grass block To be planted as P9 sized plants. Density as indicated 100% *Stipa tenuissima*, 5/m2
- Planting Block 02:** Ornamental grasses & Perennials Perennials to be planted as P9 sized plants. Density as indicated 50% *Stipa arundinacea*, 5/m2 10% *Libertia grandiflora*, 7/m2 10% *Salvia nemorosa caradonna*, 7/m2 10% *Lavandula angustifolia 'Hidcote'*, 7/m2 10% *Verbena bonariensis*, 9/m2 10% *Rudbeckia fulgida* var. *sulivantii* 'Goldsturm', 7/m2
- Planting Block 03:** Shelter Planting (6 per M2, staggered centers) 20% *Pinus sylvestris*, 1x2 xtr, 100-120mm high, 20% *Ilex aquifolium*, 1x2 xtr, 100-120mm high, 10% *Corylus avellana*, 1x2 xtr, 100-120mm high, 10% *Prunus spinosa*, 1x2 xtr, 100-120mm high, 10% *Crataegus monogyna*, 1x1 xtr, 100-120mm high, 10% *Quercus robur*, 1x2 xtr, 100-120mm, 10% *Alnus glutinosa*, 1x2 xtr, 100-120mm high, 10% *Acer campestre*, 1x2 xtr, 100-120mm high.
- Native Hedge Mix** (4 per M2 @450 staggered centers) 20% *Prunus spinosa*, 1x2 xtr, 80-100 high, 3-5 breaks, bareroot. 80% *Crataegus monogyna*, 1x1 xtr, 80-100 high, 3-5 breaks, bareroot.

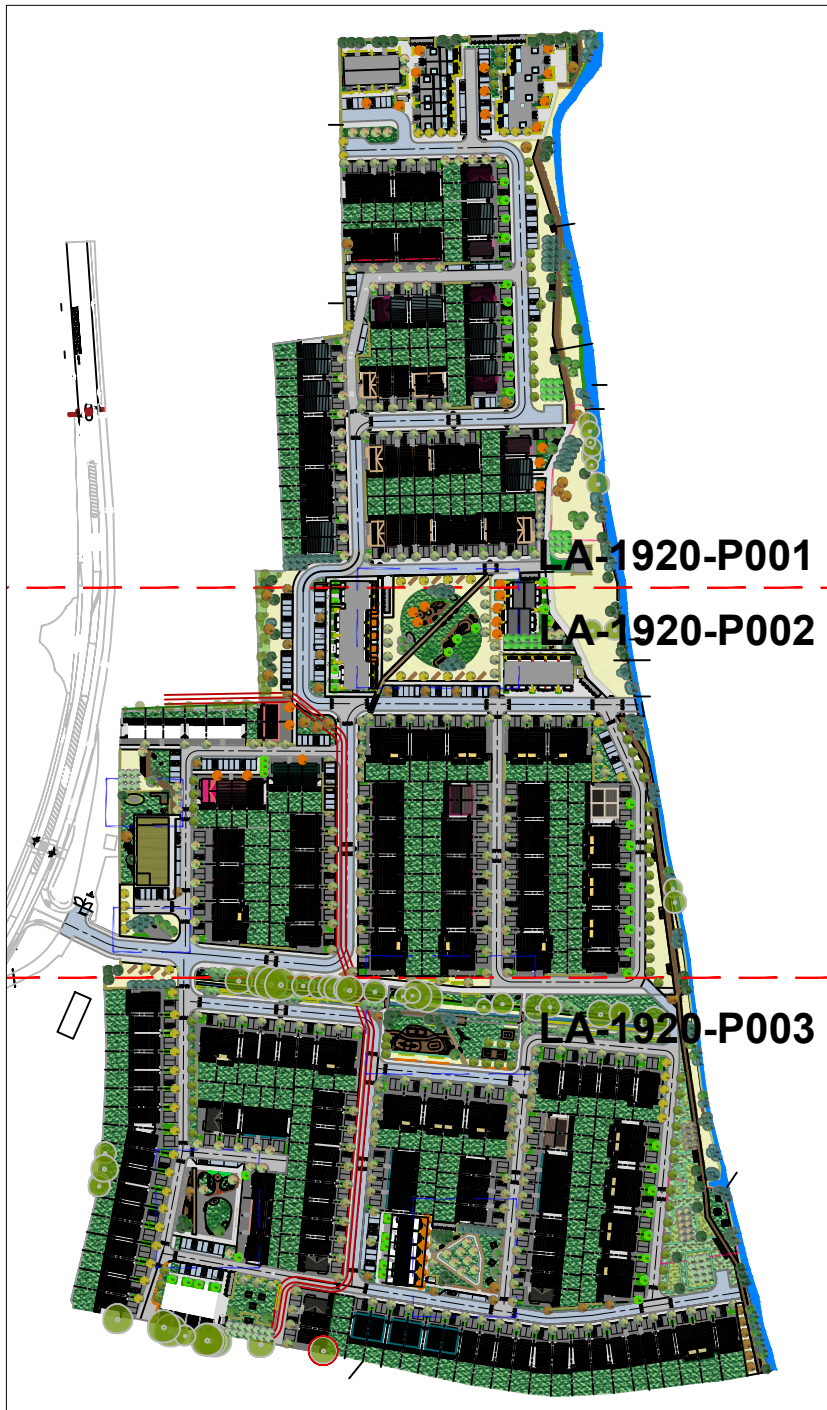

Page Layout, Not to Scale

THIS IS NOT FOR CONSTRUCTION

This drawing is the copyright of the Landscape Architect unless otherwise stated. All dimensions are in millimeters. Where dimensions are not given, drawings must not be scaled and the matter must be referred to the Landscape Architect. If the drawing includes conflicting details/dimensions the matter must be referred to the Landscape Architect. All dimensions must be checked on site. The Landscape Architect must be informed, by the contractor, of any discrepancies before work proceeds.

Cathal O'Meara
Landscape Architects
087 9202549
2 Mc Sweeney St,
Fermoy, Co. Cork

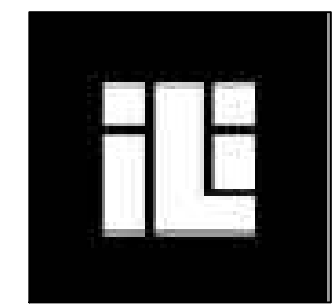

Chartered member of
the Irish Landscape
Institute

Client: Cumnor

Project: Coolcarron,
Fermoy

Drawing: Landscape
Layout 001

Date: 01/03/2022

Drawn By:
Luis Medeiros
Checked By:
Cathal O'Meara

Issue: Planning

Dwg no:1920_LA_P001
REV10

Rev	Date	Note
08	20/12/21	Layout
09	02/02/21	Layout

cathal
meara
landscape architects

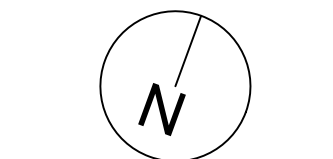

Scale 1:500, @ A1